

For Residential and Commercial Applications

Job Name _____

Contractor _____

Job Location _____

Approval _____

Engineer _____

Contractor's P.O. No. _____

Approval _____

Representative _____

Model FBV-3C-QC

2 Piece, Full-Port, Brass Ball Valves with Watts Quick-Connect Technology

Sizes: ½" – 1" (15 – 25mm)

Model FBV-3C-QC 2-piece, Full-Port Brass Quick-Connect Ball Valves are ideal for use in residential and commercial potable water applications. They feature a bottom-loaded blowout proof stem, virgin PTFE seats, thrust washer, and adjustable packing gland, stem packing nut, chrome-plated brass ball, brass adapter, and steel handle.



FBV-3C-QC

Features

- Watts integral Quick-Connect inlet and outlet connections
- Can be used with Copper, CPVC, PEX and PB pipe
- Approved to ASSE 1061
- Comes with pipe stiffeners for use with PEX
- Adjustable stem packing gland
- Virgin PTFE stem packing seal, thrust washer, and seats
- No thread sealants, solders or glues needed
- Can be rotated under pressure
- Bottom loaded blowout proof stem
- Can be removed and reused without the use of tools

Pressure – Temperature

Temperature Range: -40°F to 180°F (-40°C to 82°C)

Pressure Rating: 200psi @ 180°F (13.8 bar @ 82°C)

Specifications

Approved valves shall be 2-piece full-port design with integral Watts Quick-Connect inlet and outlet, requiring no tools, thread sealant or solder for installation and/or removal. Valve will be constructed of a forged brass body and end adapter. Seats and stem packing will be virgin PTFE. Stem shall be bottom loaded and blowout proof. Ball shall be chrome plated with an adjustable packing gland. Valve must be approved to ASSE-1061 for use with Copper, CPVC, PEX and PB pipe.

Materials

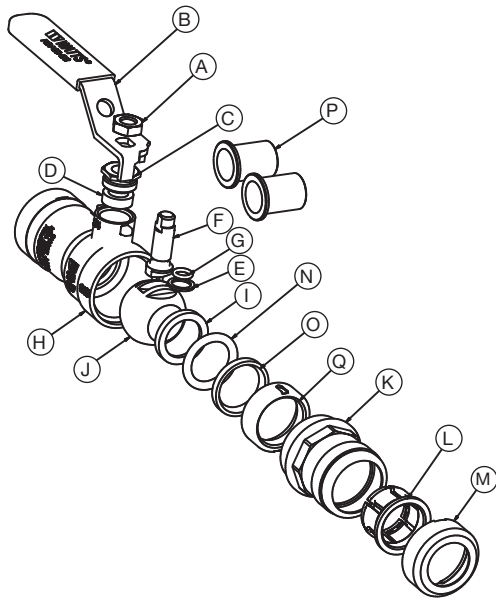

Item	Description	Material
A	Handle Nut	Zinc Plated Carbon Steel
B	Handle	Zinc Plated Carbon Steel with Vinyl Insulator
C	Packing Nut	Brass
D	Stem Packing	Virgin PTFE
E	Thrust Washer	Virgin PTFE
F	Stem	Machined Brass
G	O-Ring	Fluorocarbon Elastomer FKM
H	Body	Brass
I	Seat	Virgin PTFE
J	Ball	Chrome Plated Brass
K	Adapter	Forged Brass
L	Collet	Glass-reinforced Nylon
M	Collet Cover	HPDE
N	O-Ring	EPDM - 70 DURO
O	O-Ring Guide	Acetal
P	PEX Pipe Insert	Glass-reinforced Polysulfone
Q	Collet Retainer	Acetal

Flow Curves

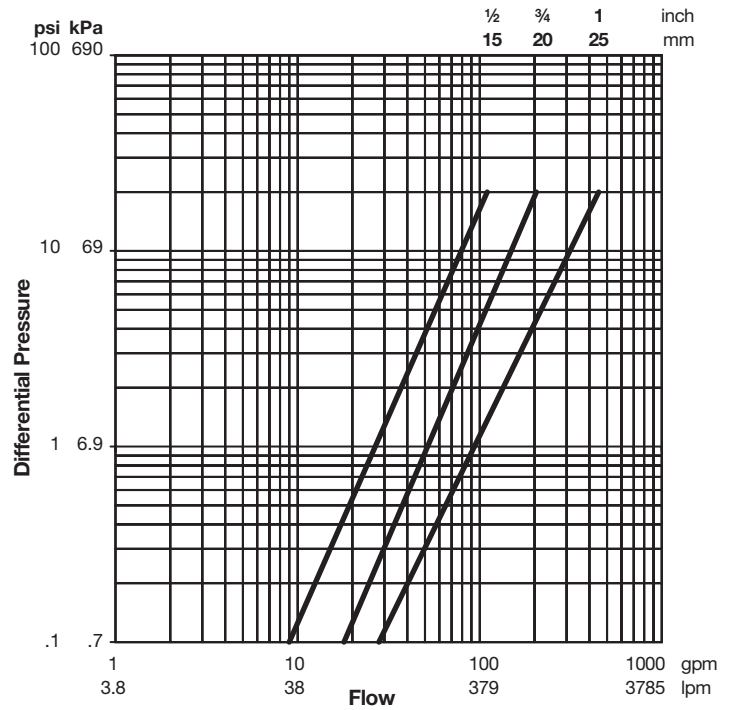

Dimensions - Weights

SIZE (DN)		DIMENSIONS										WEIGHT	
in	mm	I		C		H		L		L1		lbs.	kg
		in	mm	in	mm	in	mm	in	mm	in	mm		
1/2	15	1/2	15	1 ¹³ / ₁₆	46	3 ³ / ₈	86	3 ¹ / ₂	89	3 ¹³ / ₁₆	97	0.5	0.2
3/4	20	3/4	20	2 ¹ / ₄	58	4	101	4 ³ / ₁₆	106	4 ⁹ / ₁₆	116	0.9	0.4
1	25	1	25	2 ⁵ / ₈	67	4 ¹ / ₄	107	4 ⁹ / ₁₆	116	5	127	1.4	0.6

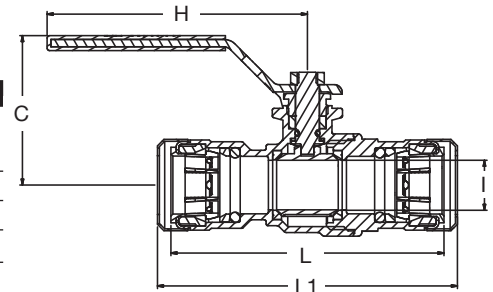

WATTS®

Water Safety & Flow Control Products

ISO 9001-2000
CERTIFIED

USA: 815 Chestnut St., No. Andover, MA 01845-6098; www.watts.com
Canada: 5435 North Service Rd., Burlington, ONT. L7L 5H7; www.wattscanada.ca